

Drain: SPRINGMILL VILLAGES DRAIN **Drain #:** 268
Improvement/Arm: THE MEADOWS - SECTION 2
Operator: JPH **Date:** 5-18-04
Drain Classification: Urban/Rural **Year Installed:** 1994

GIS Drain Input Checklist

- Pull Source Documents for Scanning JPH
- Digitize & Attribute Tile Drains N/A
- Digitize & Attribute Storm Drains JPH
- Digitize & Attribute SSD JPH
- Digitize & Attribute Open Ditch N/A
- Stamp Plans JPH
- Sum drain lengths & Validate JPH
- Enter Improvements into Posse JPH
- Enter Drain Age into Posse JPH
- Sum drain length for Watershed in Posse JPH
- Check Database entries for errors JPH

Gasb 34 Footages for Historical Cost Drain Length Log

Drain-Improvement: SPRINGMILL VILLAGES DRAIN - THE MEADOWS - SECTION 1

Drain Type:	Size:	Length	Length (DB Query)	Length Reconcile	Price:	Cost:
SSD	6"	2,076'	2,076'	Ø	2.00	4,152.00
RCP	12"	552'	552'	Ø	7.25	4,002.00
	15"	492'	492'	Ø	9.50	4,674.00
	18"	110'	110'	Ø	10.50	1,155.00
	21"	443'	443'	Ø	14.25	6,312.75
	24"	355'	355'	Ø	18.00	6,390.00
	30"	33'	33'	Ø	24.60	811.80
Sum:		4,061'	4,061'	Ø		\$27,497.55

Final Report: _____

Comments:

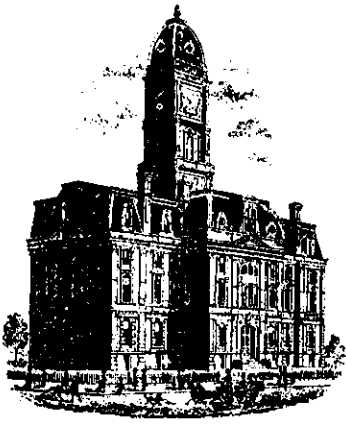

SURVEYOR'S OFFICE

Hamilton County

Kenton C. Ward, Surveyor

Suite 146

776-8495

One Hamilton County Square

Noblesville, Indiana 46060-2230

November 14, 1994

TO: Hamilton County Drainage Board

RE: Springmill Villages Drain
The Meadows Section 1 Arm

Attached is a petition, non-enforcement request, plans, calculations, quantity summary and assessment roll for the Springmill Villages Drain, The Meadows Section 1 Arm. I have reviewed the submittals and petition and have found each to be in proper form.

I have made a personal inspection of the land described in the petition. Upon doing so, I believe that the drain is practicable; will improve the public health; benefit a public highway and be of public utility; and that the costs, damages and expenses of the proposed drain will probably be less than the benefits accruing to the owners of land likely to be benefited. The drain will consist of the following:

6"	SSD	2076 feet	21"	RCP	442 feet
12	RCP	647 feet	24"	RCP	356 feet
15"	RCP	414 416 feet	30"	RCP	30 feet
18"	RCP	110 feet			

The total length of the drain will be 4,077 feet.

The retention pond located at the rear of Lots 1 to 4 and Lots 6 and 7 is not to be considered part of the regulated drain. Only the inlet and outlet will be maintained as part of the regulated drain. The maintenance of the pond will be the responsibility of the Homeowners Association. The Board will however, retain jurisdiction for ensuring the storage volume for which the pond was designed will be retained. Thereby, allowing no fill or easement encroachments.

The subsurface drains (SSD) to be part of the regulated drain are those located under the curbs and those main lines between lots or in rear yards. Only the main SSD lines which are located within the easement are to be maintained as regulated drain. Laterals for individual lots will not be considered part of the regulated drain.

The open ditch listed above includes the portion from the outlet at STRUCTURE 135 to the pond and from the South end of the existing 18 x 18 concrete box culvert under 151st Street to the pond.

I have reviewed the plans and believe the drain will benefit each lot equally. Therefore, I recommend each lot be assessed equally. I also believe that no damages will result to landowners by the construction of this drain. I recommend a maintenance assessment of \$30.00 per lot, \$5.00 per acre for roadways, with a \$30.00 minimum. With this assessment the total annual assessment for the this section will be \$ 660.00.

Parcels assessed for this drain may be assessed for the Overman-Harvey Drain and/or Village Farms Drain at sometime in the future.

I believe this proposed drain meets the requirements for Urban Drain Classification as set out in IC 36-9-27-67 to 69. Therefore, this drain shall be designated as an Urban Drain.

I recommend that upon approval of the above proposed drain that the Board also approve the non-enforcement request. This request is for the reduction of the regulated drain easement to those easement widths as shown on the secondary plat for The Meadows Section 1 at Springmill Villages Drain as recorded in the office of the Hamilton County Recorder.

I recommend the Board set a maintenance hearing for this proposed drain for December 1994.

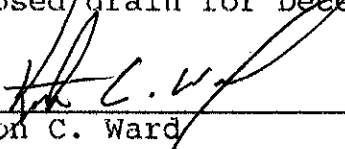

Kenton C. Ward
Hamilton County Surveyor
KCW/no

CERTIFICATE OF COMPLETION AND COMPLIANCE

TO: HAMILTON COUNTY SURVEYOR
RE: The Meadows Section I
@ Springmill Villages

FILED

OFFICE OF HAMILTON COUNTY SURVEYOR

I hereby certify that:

- 1.) I am a Registered Engineer in the State of Indiana,
- 2.) I am familiar with the plans and specifications for the above referenced subdivision,
- 3.) I have personally observed and supervised the completion of the Drainage Facilities for the above referenced subdivision, and
- 4.) To the best of my knowledge, information and belief, the Drainage Facilities within the subdivision has been installed and completed in conformity with all plans and specifications.

Signature: *Duane A. Sharrer* Date: 9/1/94
 Type or Printed Name: Duane A. Sharrer
 Business Address: 3020 North Post Road
 Indianapolis, IN 46226
 Telephone: 317-898-8282

INDIANA REGISTRATION NUMBER
 890258

SEAL





SURVEYOR'S OFFICE

Hamilton County

Kenton C. Ward, Surveyor

Phone (317) 776-8495

Fax (317) 776-9628

Suite 146

One Hamilton County Square

Noblesville, Indiana 46060-2230

May 9, 1996

To: Hamilton County Drainage Board

Re: Springmill Villages Drain
The Meadows, Section 1 Arm

Attached are as-builts, certificate of completion & compliance, and other information for The Meadows Section 1. An inspection of the drainage facilities for this section has been made and the facilities were found to be complete and acceptable.

During construction, changes were made to the drain which will alter the plans submitted with my report for this drain dated November 14, 1994. The changes are as follows:

STR 117-118 consists of 15" RCP at 75' feet. This structure was upgraded from a 12" RCP at 78' feet.

STR 175-151 30" RCP lengthened from 30' feet to 33' feet.

STR 152-153 24" RCP lengthened from 232' feet to 233' feet.

STR 153-154 24" RCP shortened from 28' feet to 26' feet.

STR 154-155 21" RCP lengthened from 31' feet to 32' feet.

STR 155-156 21" RCP lengthened from 300' feet to 301' feet.

STR 156-115 21" RCP shortened from 111' feet to 110' feet.

STR 123-121 12" RCP shortened from 40' feet to 39' feet.

STR 122-121 12" RCP shortened from 36' feet to 34' feet.

STR 121-115 12" RCP lengthened from 27' feet to 28' feet.

STR 120-117 12" RCP lengthened from 155' feet to 156' feet.

STR 118-119 12" RCP shortened from 140' feet to 123' feet.

STR 114-113 12" RCP lengthened from 171' feet to 172' feet.

STR 113-112 15" RCP shortened from 28' feet to 26' feet.

STR 111-110 15" RCP lengthened from 130' feet to 135' feet.

The length of the drain due to the changes described above is now 4061 feet.

The non-enforcement was approved by the Board at its meeting on December 27, 1994.

Springmill Villages , The Meadows was not bonded.

I recommend the Board approve the drains construction as complete and acceptable.

Sincerely,

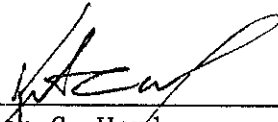

Kenton C. Ward
Hamilton County Surveyor

KCW/ndw

POND
N.P. = 900.00

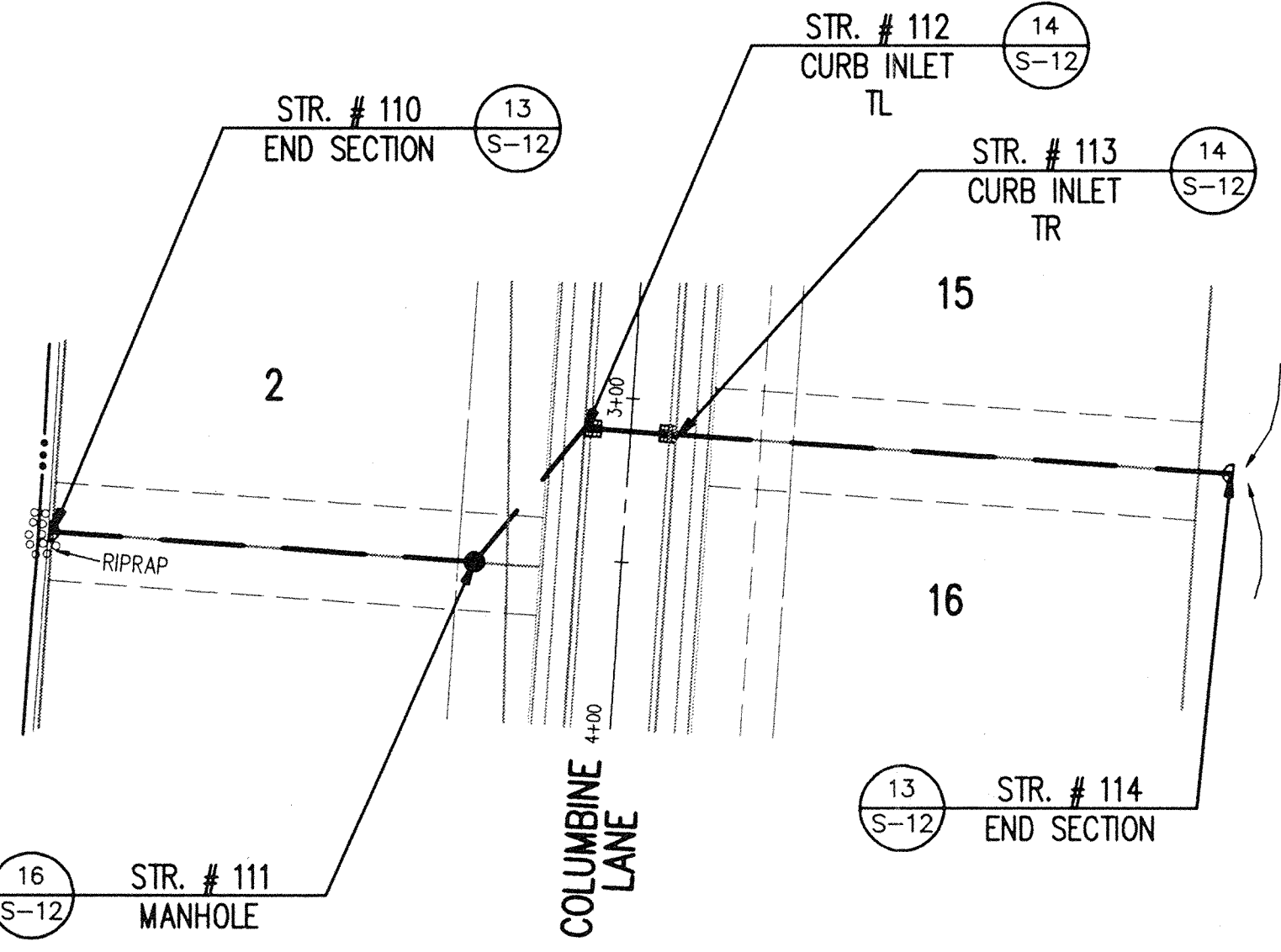
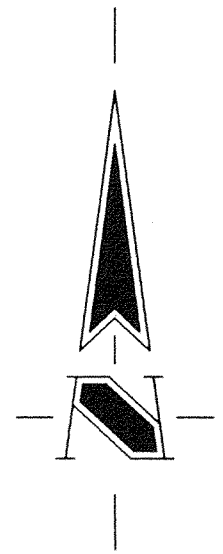

CERTIFICATION FOR "RECORD DRAWING"

CERTIFIED BY: *Richard J. Raylock*

SCHNEIDER ENGINEERING CORPORATION
3020 NORTH POST ROAD
INDIANAPOLIS, INDIANA 46226-6518
P.O. BOX 28068 (317) 898-8282

NOTE:
Record drawing certification only for top of casting, invert elevations and lengths of pipe. Slope percentage represents a calculated figure and is for general information only.

DATE: 9-6-94

- GENERAL NOTES:
- ALL CUTS ARE TAKEN FROM THE EXISTING GRADE TO THE PIPE INVERT.
 - ALL STATIONING IS TAKEN FROM THE NEAREST DOWNSTREAM STRUCTURE.
 - IT SHALL BE THE CONTRACTOR'S RESPONSIBILITY TO FIELD VERIFY ALL UTILITY LOCATIONS BEFORE CONSTRUCTION BEGINS.
 - TEMPORARY TRAFFIC CONTROL DURING CONSTRUCTION TO CONFORM TO APPLICABLE LOCAL AND STATE STANDARDS.
 - ALL CONSTRUCTION ACTIVITY ON THIS SITE TO BE PERFORMED IN COMPLIANCE WITH APPLICABLE O.S.H.A. STANDARDS FOR WORKER SAFETY.
 - CONTRACTOR SHALL MINIMIZE DAMAGE TO EXISTING TREES.

POND
N.P. = 900.00

STR. # 119
END SECTION

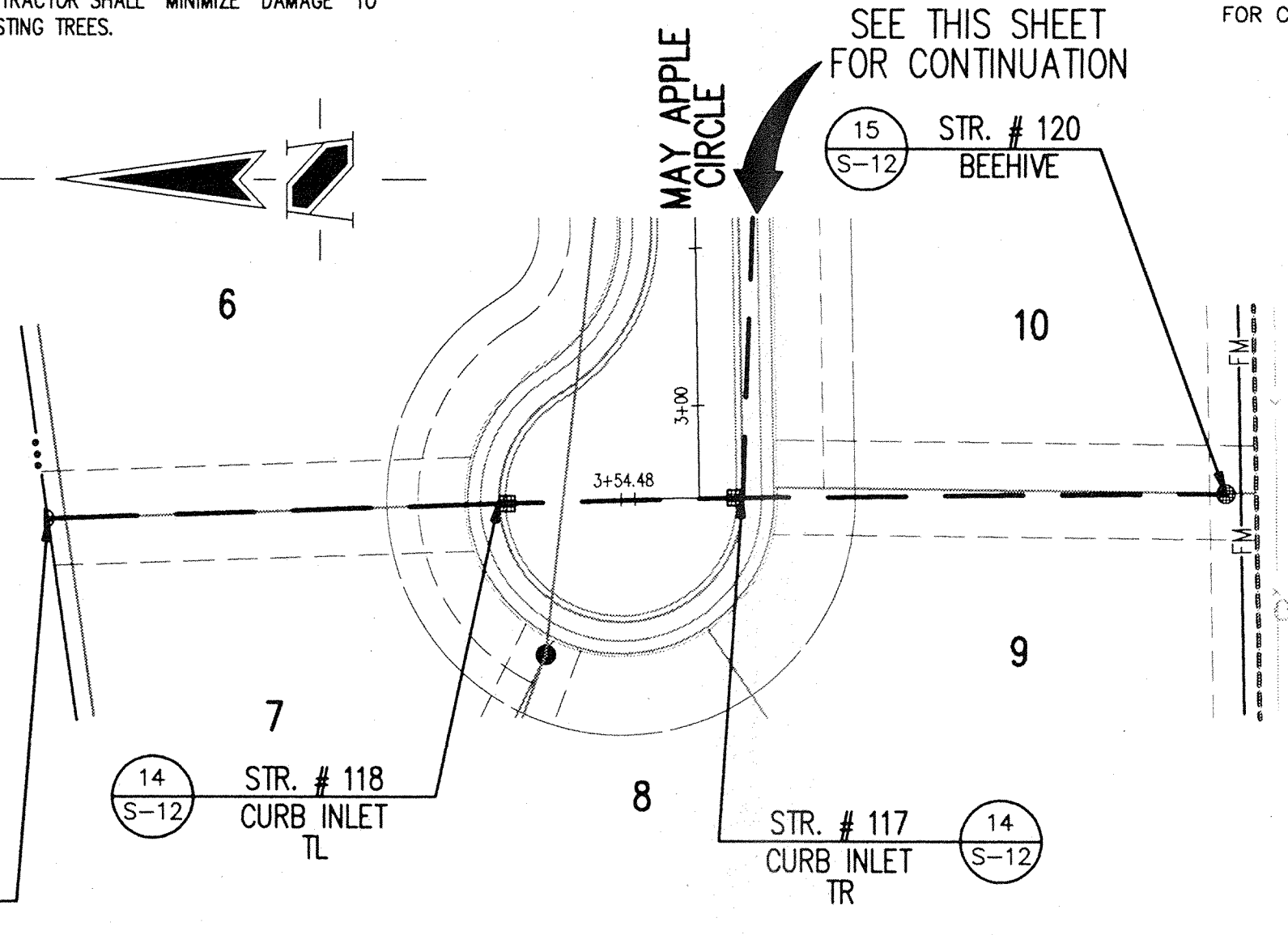

HOLEY MOLEY SAYS
"DON'T DIG BLIND"

1-800-382-5544
CALL TOLL FREE
1-800-428-5200
FOR CALLS OUTSIDE OF INDIANA

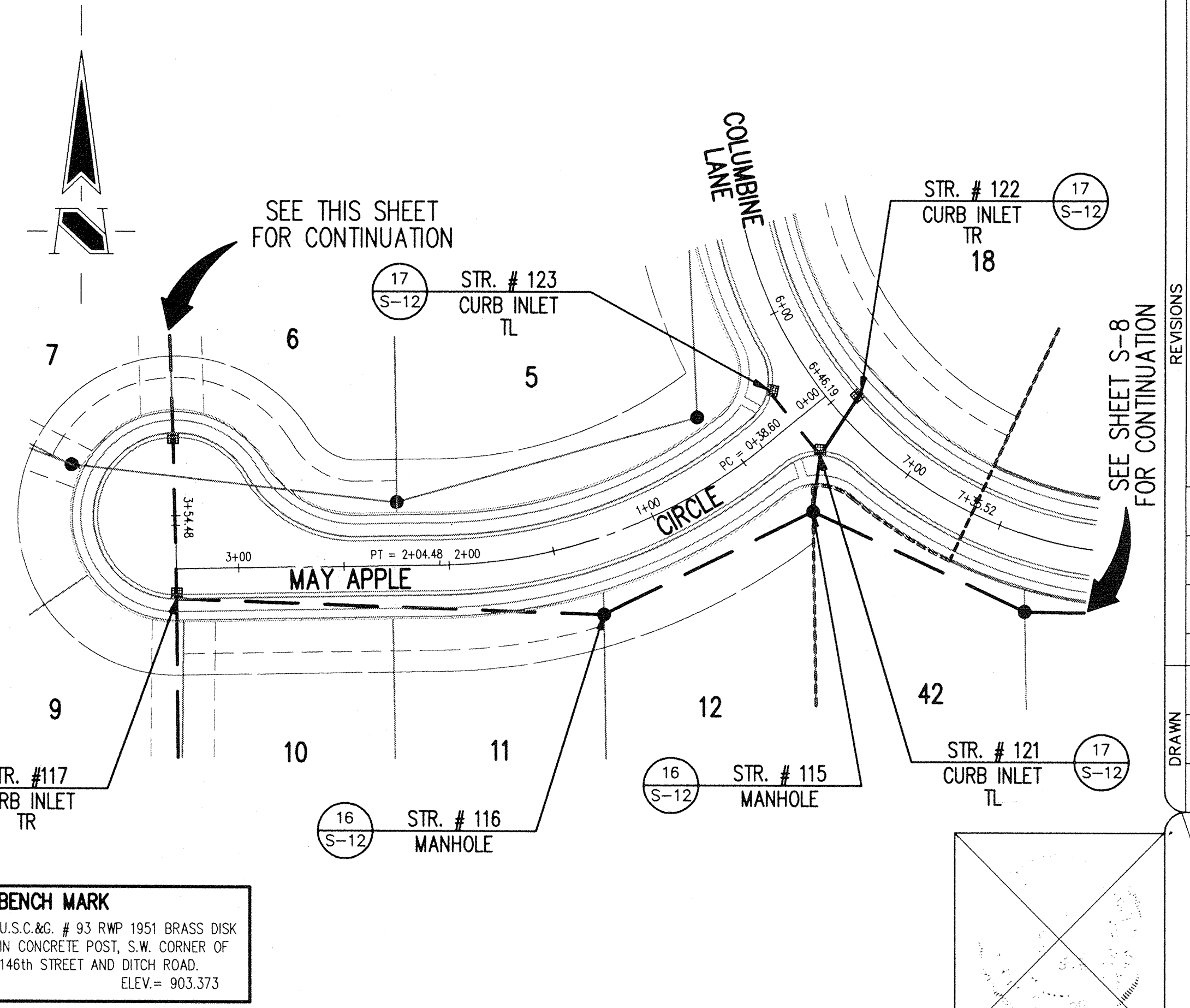

BENCH MARK
U.S.C.&G. # 93 RWP 1951 BRASS DISK
IN CONCRETE POST, S.W. CORNER OF
146th STREET AND DITCH ROAD.
ELEV. = 903.373

STORM SEWER PLAN

SCALE: 1" = 50'

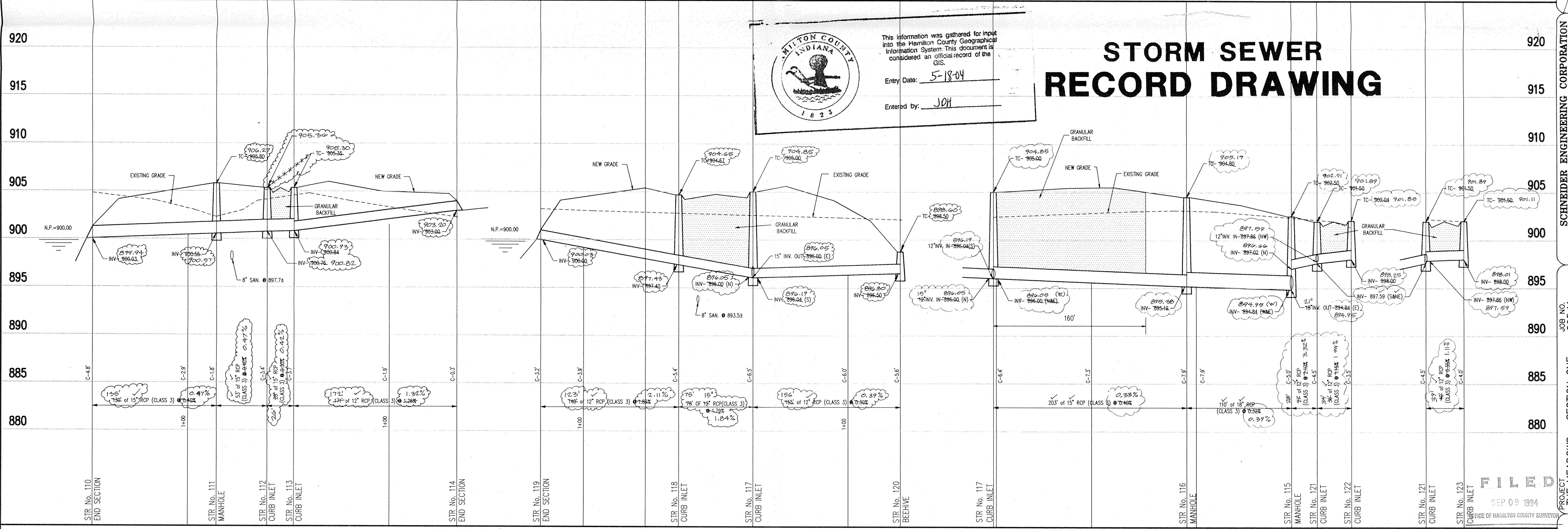

MILTON COUNTY INDIANA

This information was gathered for input into the Hamilton County Geographical Information System. This document is considered an official record of the GIS.

Entry Date: 5-18-04

Entered by: JOH

STORM SEWER RECORD DRAWING

STORM SEWER PROFILE

SCALE: HORIZ.: 1" = 50'
VERT.: 1" = 5'

REVISIONS

NO.	DATE	BY	CHECK	DESCRIPTION
1	1/17/94	DAP	1/17/94	ADDED GRANULAR BACKFILL & REISED TO GRADES

PROJECT: THE MEADOWS SECTION ONE
JOB NO. 895.11
PREPARED FOR: BRENNICK DEVELOPMENT CO., INC.
TITLE: STORM SEWER PLAN & PROFILE

FILED
SEP 09 1994
OFFICE OF HAMILTON COUNTY SURVEYOR

SHEET OF 7
13

CERTIFICATION FOR "RECORD DRAWING"

CERTIFIED BY: *Richard G. Payne*

RICHARD G. PAYNE
REGISTERED
No. 870015
STATE OF INDIANA
LAND SURVEYOR

DATE: 9-6-94

NOTE:
Record drawing certification only for top of casing, invert elevations and lengths of pipe. Slope percentage represents a calculated figure and is for general information only.

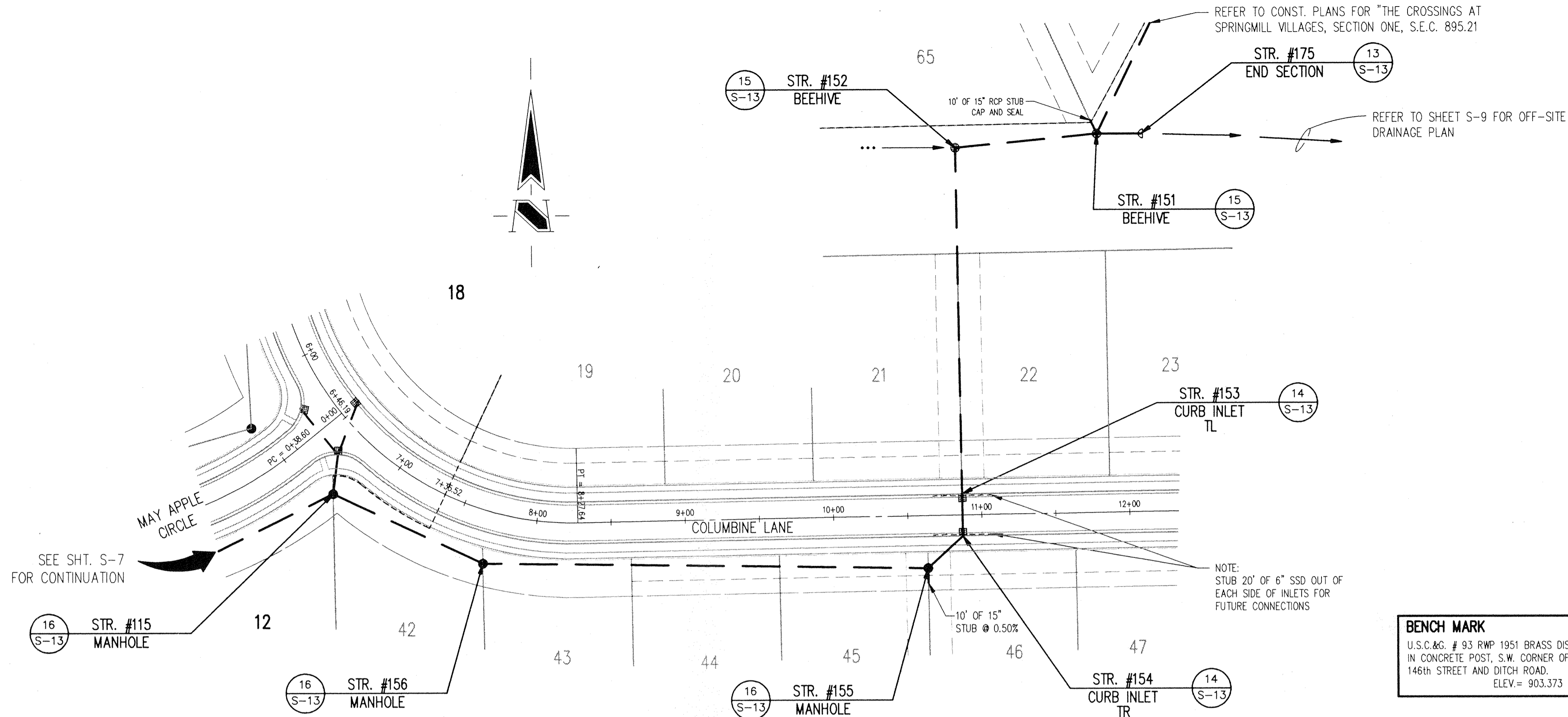

HOLEY MOLEY SAYS
"DON'T DIG BLIND"

1-800-382-5544
CALL TOLL FREE
1-800-428-5200
FOR CALLS OUTSIDE OF INDIANA

GENERAL NOTES:

- ALL CUTS ARE TAKEN FROM THE EXISTING GRADE TO THE PIPE INVERT.
- ALL STATIONING IS TAKEN FROM THE NEAREST DOWNSTREAM STRUCTURE.
- IT SHALL BE THE CONTRACTOR'S RESPONSIBILITY TO FIELD VERIFY ALL UTILITY LOCATIONS BEFORE CONSTRUCTION BEGINS.
- TEMPORARY TRAFFIC CONTROL DURING CONSTRUCTION TO CONFORM TO APPLICABLE LOCAL AND STATE STANDARDS.
- ALL CONSTRUCTION ACTIVITY ON THIS SITE TO BE PERFORMED IN COMPLIANCE WITH APPLICABLE O.S.H.A. STANDARDS FOR WORKER SAFETY.
- CONTRACTOR SHALL MINIMIZE DAMAGE TO EXISTING TREES.

REVISIONS	DATE	CHECK NO.	BY	DATE	CHECK

DRAWN BY: *James J. Schaefer*
DATE: 9/9/94
CERTIFIED

STORM SEWER PLAN

SCALE: 1" = 50'

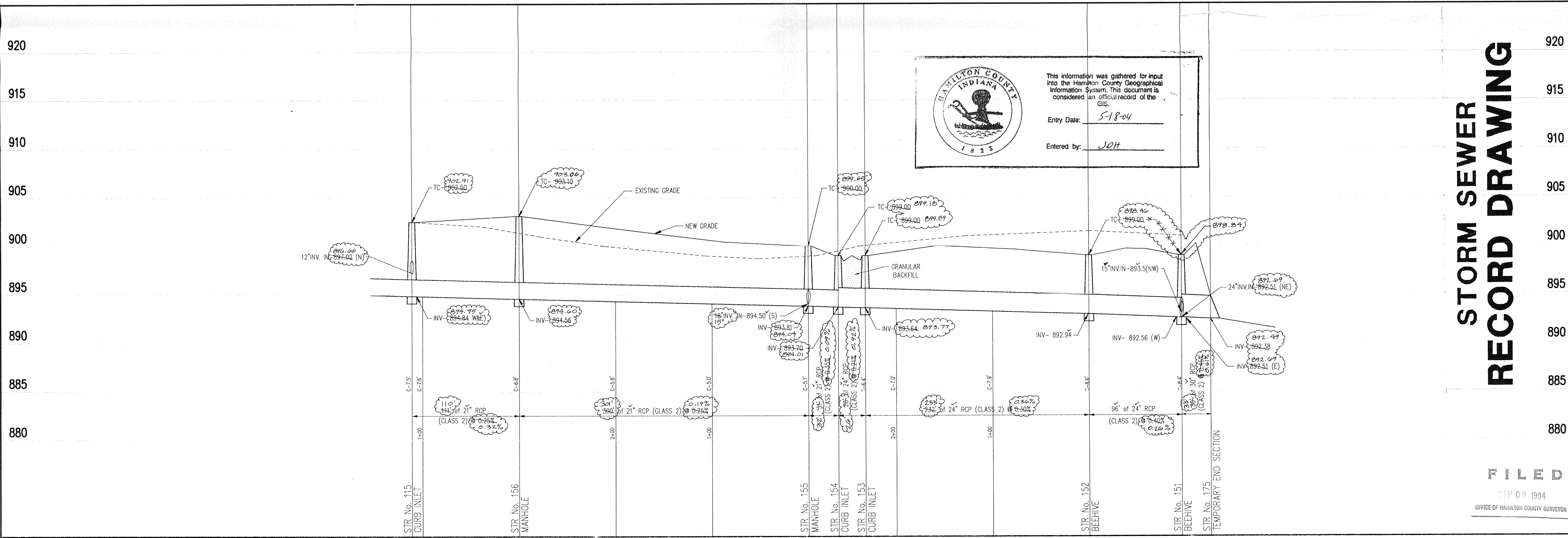

STORM SEWER RECORD DRAWING

STORM SEWER PROFILE

SCALE: HORIZ.: 1" = 50'
VERT.: 1" = 5'

SCHNEIDER ENGINEERING CORPORATION
Professional Engineers • Land Planners • Geologists
Land Surveyors

3020 NORTH POST ROAD
INDIANAPOLIS, INDIANA 46226-6518
Telephone: (317) 898-8882 Fax: (317) 898-8010

8845 EAST U.S. 36, SUITE 500
DANVILLE, INDIANA 46122
Telephone: (317) 772-0412 Fax: (317) 772-0412

JOB NO. 895.11
SECTION ONE
PREPARED FOR
BRENNICK DEVELOPMENT CO. INC.
TITLE
OFFSITE STORM SEWER PLAN & PROFILE

SCALE: SHOWN

SHEET
S-8
OF
13

This copy printed from the Digital Archive of the Hamilton County Surveyor's Office: One Hamilton Co. Square, Ste. 188, Noblesville, In 46060